



AMERICAN FLOOR PRODUCTS COMPANY, INC.

AFCO-USA

P.O. BOX 7055 • Gaithersburg, Maryland 20898 -7055 • 301-987-0490 • Fax 301-987-0422

email: sales@afco-usa.com • Web Site: www.afco-usa.com

INSTALLATION INSTRUCTIONS

Style: VENUS® One Piece Partition End Guard (CG-2130) Tape System

Step 1: Measure, square and cut both aluminum retainers to "as built" ceiling heights.

Step 2: As a guide, use a chalk line or a metal or wood "spacer" to insure that both retainers will be parallel and spaced equally from one another.

Step 3: Mount retainers with S.M.S. 18" O.C

Step 4: With Tape systems, tape and paint

Step 5: Install Rubber Bumper Strips (2)

Step 6: If necessary, measure, square and trim vinyl corner guard cover. Remove flash and snap onto aluminum retainer.

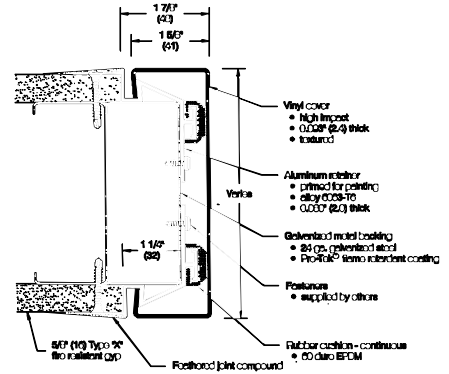

Section 3 - Flush Mounted (Fire Rated, 1 or 2 Hour)

Styles: VENUS® 90° (CG-2160) Tape System
ANDROMEDA® (CG-2167) Tape System

Step 1: Cut back or trim second layer of drywall to accept fire rated corner guard system to the height of the finished corner guard.

NOTE: The space created by removing the first layer of drywall must be a snug fit for the painted galvanized steel angle with insulation on the back

Step 2: Measure, square and cut aluminum retainer to "as built" ceiling heights if ceiling is fire rated

Step 3: Place the fire rated corner guard retainer, together with the insulation and painted galvanized steel angle, in the opening created by removing the top layer of drywall.

Fasten with S.M.S., 3" from each end, on each flange, and 24" O.C. thereafter.

NOTE: The insulation goes towards the drywall and the steel angle is towards the aluminum retainer

Step 4: With Tape systems, tape and paint.

Step 5: Measure, square and trim vinyl corner guard cover. Remove flash and snap onto aluminum retainer.

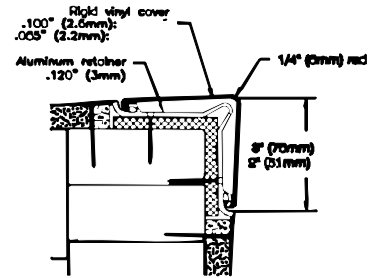

CG-2160 / CG-2167 Tape - 1Hour

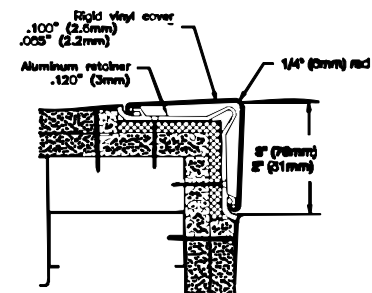

CG-2160 / CG-2167 Tape - 2Hour

Installation Style:

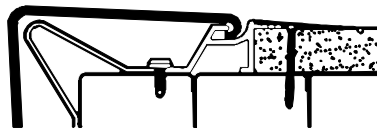

Tape - For Taped Joint Finish